

- PNEUMATIC OPTIONS
- ELECTRICAL OPTIONS
- TUBE/MOUNT TOOLING OPTIONS
- COMPATIBLE CUSTOMIZATION
- IMMEDIATE PLUG AND PLAY
- REPLENISHABLE INVENTORY
- UNIVERSAL PARTS FOR BUILDS
- 1000'S OF PARTS IN STOCK
- 24 HOUR TURNAROUND TIME

**ALL IN-HOUSE REPLACEMENT PART SERVICE**

## ALUMINUM TUBING



Tech-Effector aluminum tubing is manufactured from lightweight, high strength aluminum. Available in a variety of sizes. Optimized design assures a good combination of weight and deflection characteristics.

### Features

- Lightweight and robust
- Black anodize finish
- Precision OD for best performance
- Length available in 5mm steps

### Ordering Information

Part No.	Description	Weight
TE-RT100E13-L (LENGTH in 5 mm steps)	1.00 inch diameter x 1/8 inch wall, Aluminum Tube	0.6 kg/m [0.41 lbs/ft]
TE-RT125E13-L (LENGTH in 5 mm steps)	1.25 inch diameter x 1/8 inch wall, Aluminum Tube	0.8 kg/m [0.51 lbs/ft]
TE-RT150E13-L (LENGTH in 5 mm steps)	1.50 inch diameter x 1/8 inch wall, Aluminum Tube	0.9 kg/m [0.61 lbs/ft]

\*Minimum length is 50mm, Maximum length is 3000mm, Order in 5mm increments (steps).

- Additional options available upon request

1.00 inch Aluminum Tubing

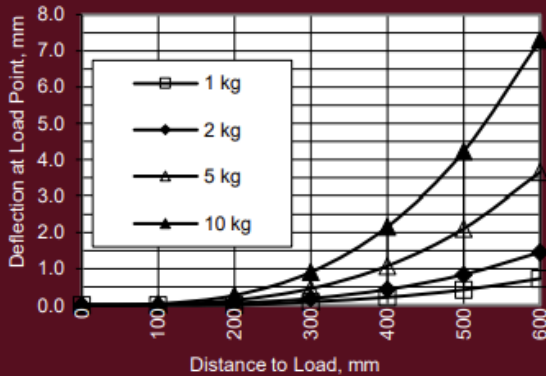

1.25 inch Aluminum Tubing

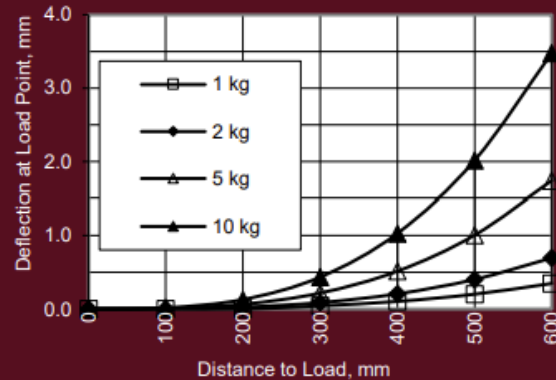

1.50 inch Aluminum Tubing

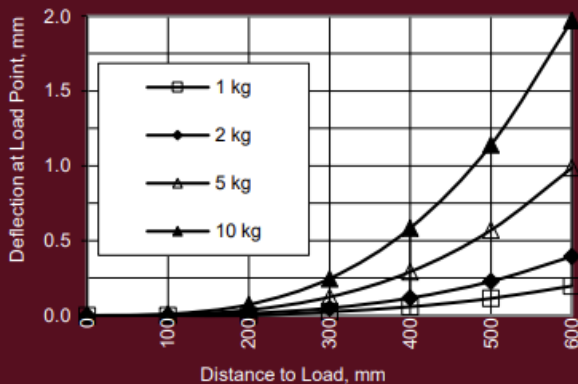

2.50 inch Aluminum Tubing

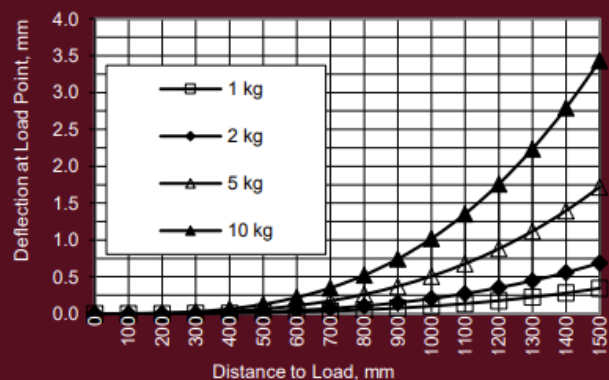

## TE-LRA20, TOOLING ADAPTER



The TE-LRA20 Tooling Adapter is an industry standard manual tool changer. For use on new or existing tri-axis and crossbar pressroom applications.

### Features

- Plug and Play compatibility
- Lightweight Aluminum
- Pneumatic/Electrical Options
- Tube/Mount Tooling Options

### Ordering Information

Part No.	Description	Weight
TE-LRA20125SA4ENN	Tooling Adaptor, 125S, 1.25 inch ID Knurl, (2) 1/4 inch Ports, 4-Pin Connector, Straight	0.5 kg [1.1 lbs]
TE-LRA20125SNNNN	Tooling Adaptor, 125S, 1.25 inch ID Knurl, No Air, No Electrical	0.4 kg [0.9 lbs]
TE-LRA20150DANNN	Tooling Adaptor, 1.50 inch Stud, 2-Ports ¼ Air, No Electrical	0.5 kg [1.0 lbs]
TE-LRA20125DANNN	Tooling Adaptor, 1.25 inch Stud, 2-Ports ¼ Air, No Electrical	0.4 kg [1.0 lbs]
TE-LCH1175	Clamp Collar for UN/125S Mount Options	0.3 kg [0.2 lbs]

- Additional options available upon request

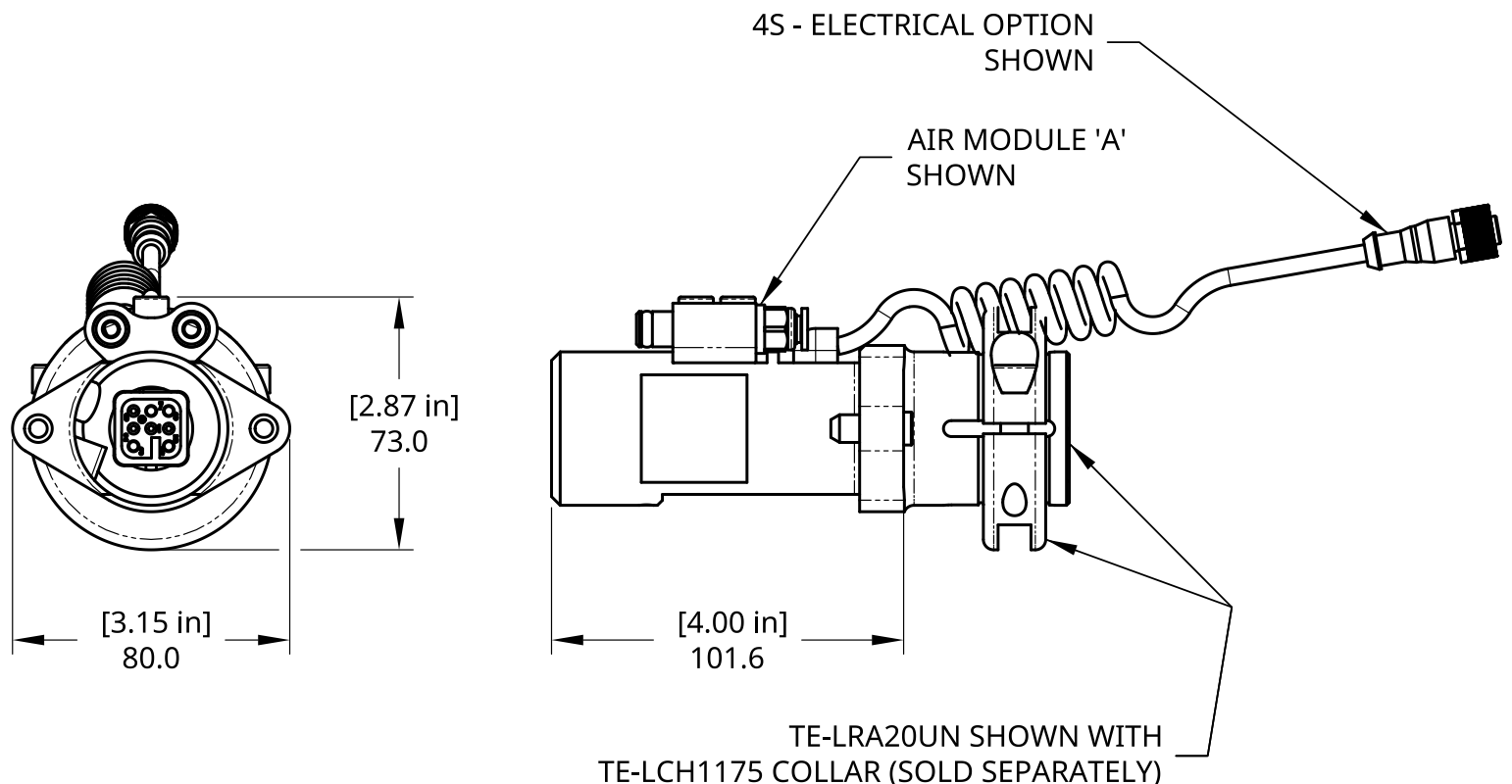

## TE-RDC, TOOLING ADAPTER (BAYONET)

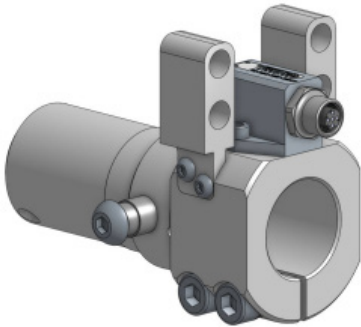

The TE-RDC Tooling Adapter (Bayonet) is an industry standard manual tool changer. For use on new or existing tri-axis and crossbar pressroom applications.

### Features

- Plug and Play compatibility
- Lightweight Aluminum
- Pneumatic Options
- Tube/Mount Tooling Options
- Electrical Options

### Ordering Information

Part No.	Description	Weight
TE-RDC15	Tooling Adaptor, 1.50 inch, NO Air Manifold, NO Electrical	0.6 kg [1.3 lbs]
TE-RDC-15-MC	Tooling Adaptor, 1.50 inch, NO Air Manifold, 5-Pin M12 Connector	0.7 kg [1.5 lbs]
TE-RDC-15-E4-HF	Tooling Adaptor, 1.50 inch, (4) 1/4 inch Ports, NO Electrical	0.7 kg [1.5 lbs]
TE-RDC-15-E4-MC-HF	Tooling Adaptor, 1.50 inch, (4) 1/4 inch Ports, 5-Pin M12 Connector	0.8 kg [1.7 lbs]
TE-RDB-M5P-5MCF	Pass-Thru Connector, 5-Pin M12	0.1 kg [0.2 lbs]

- Additional options available upon request

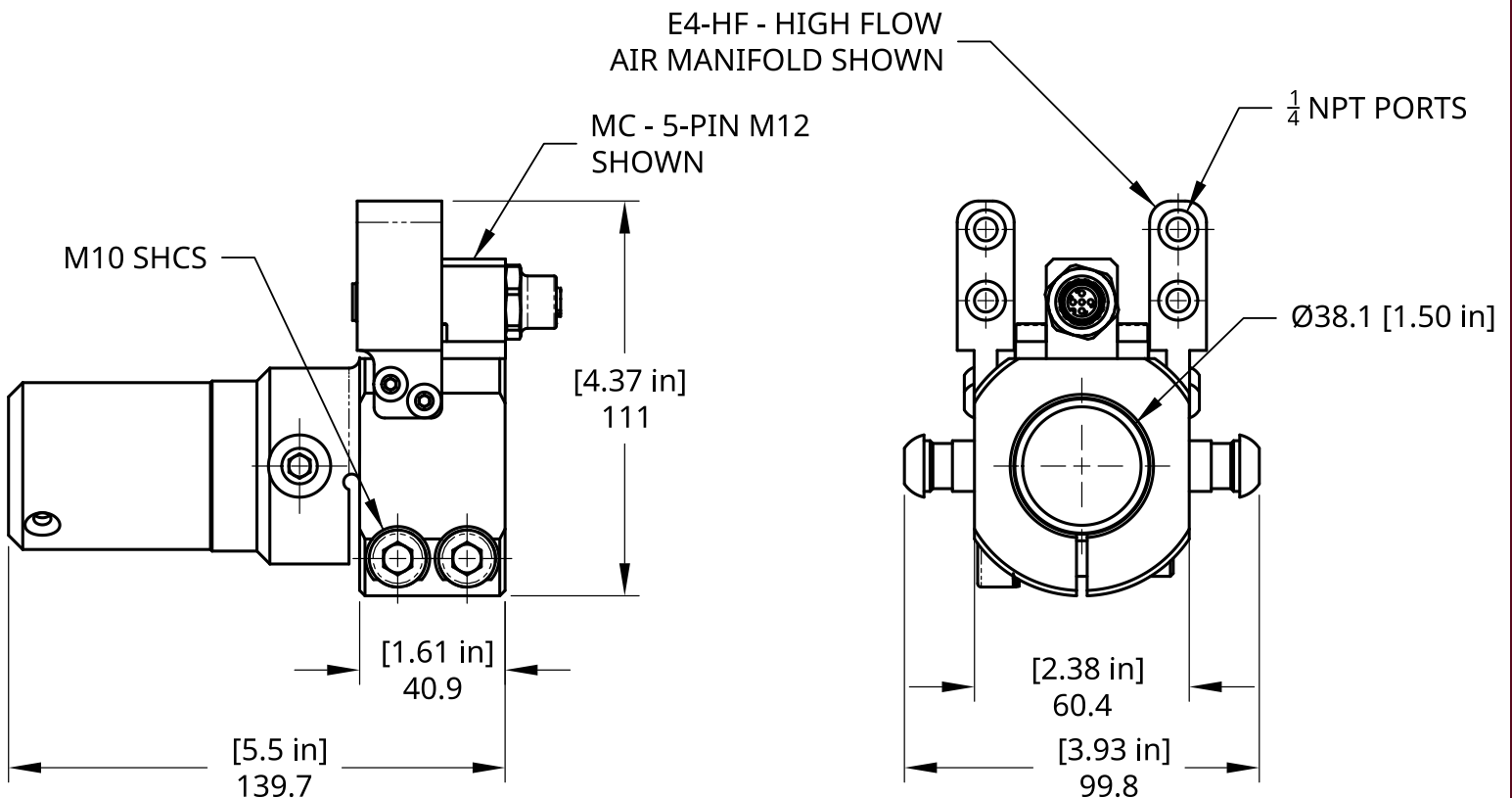

## HORIZONTAL FLANGE MOUNT

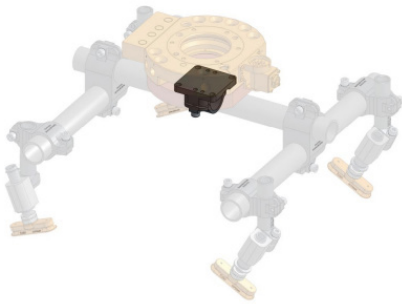

Tech-Effector TE-HFM Horizontal Flange Mount is a versatile component used in lightweight end effector designs. It provides a simple means for securing tubing to mount plates and tool changers.

### Features

- High strength aluminum
- Square M8 mounting hole pattern
- Dowel holes for precise location

### Ordering Information

Part No.	Description	Weight
TE-HFM15	Flange Mount, 1.50 inch diameter	0.26 kg [0.58 lbs]

- Additional options available upon request

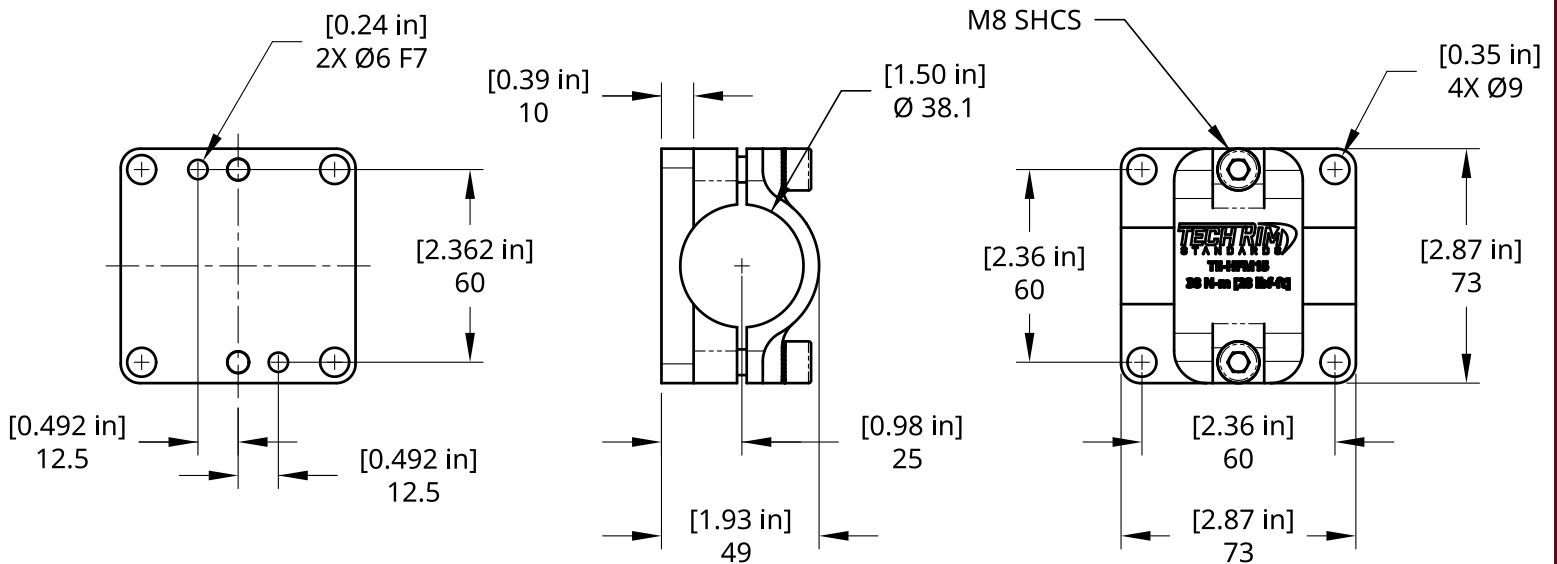



## CROSS CLAMPS



Tech-Effector cross clamps are manufactured from **lightweight**, High strength aluminum. Available in a variety of sizes. Optimized design assures minimum tooling weight and maximum holding power.

### Features

- Lightweight and robust
- Class 12.9, M8 fasteners
- Laser etched for reliable part identification

### Ordering Information

Part No.	Description	Weight
TE-CC1010	1.00 inch to 1.00 inch, Cross Clamp	0.12 kg [0.26 lbs]
TE-CC1313	1.25 inch to 1.25 inch, Cross Clamp	0.19 kg [0.42 lbs]
TE-CC1310	1.25 inch to 1.00 inch, Cross Clamp	0.15 kg [0.33 lbs]
TE-CC1515	1.50 inch to 1.50 inch, Cross Clamp	0.29 kg [0.64 lbs]
TE-CC1513	1.50 inch to 1.25 inch, Cross Clamp	0.19 kg [0.42 lbs]
TE-CC1510	1.50 inch to 1.00 inch, Cross Clamp	0.17 g [0.38 lbs]

• Additional options available upon request

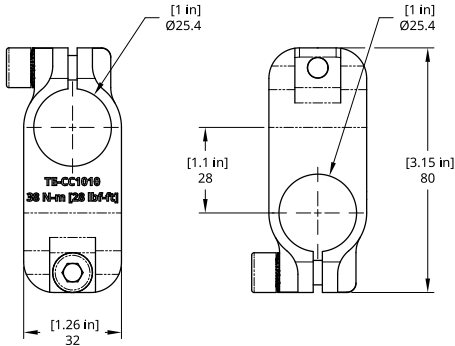
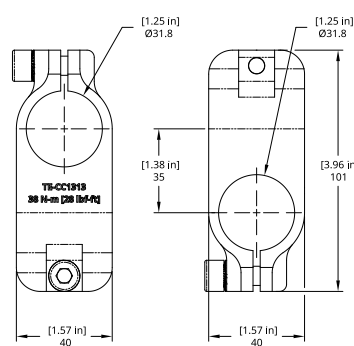
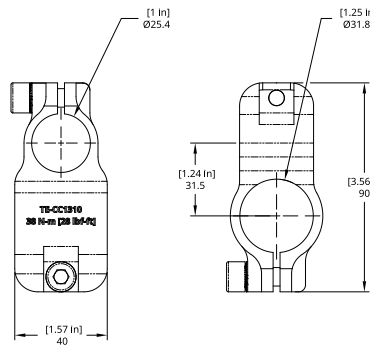
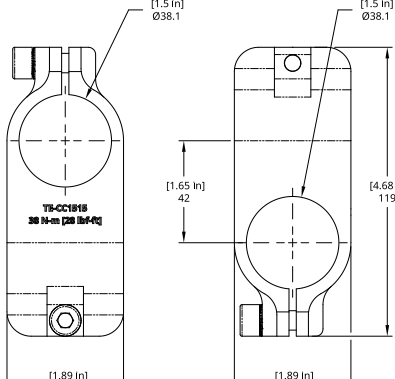
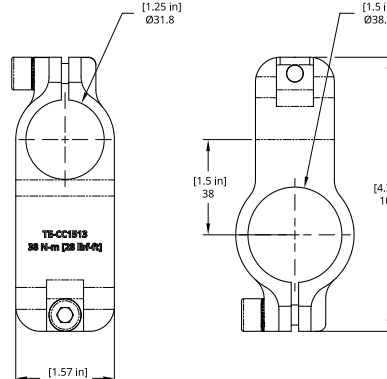
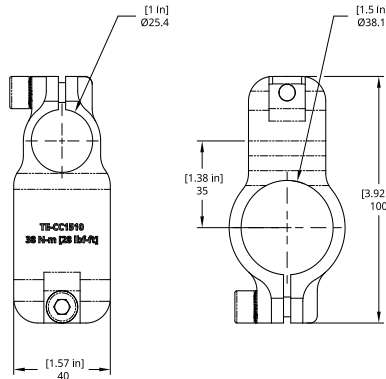
 <p>TE-CC1010 38 N-m [28 lbf-ft]</p>	 <p>TE-CC1313 38 N-m [28 lbf-ft]</p>	 <p>TE-CC1310 38 N-m [28 lbf-ft]</p>
<p><b>TE-CC1010</b></p>	<p><b>TE-CC1313</b></p>	<p><b>TE-CC1310</b></p>
 <p>TE-CC1515 38 N-m [28 lbf-ft]</p>	 <p>TE-CC1513 38 N-m [28 lbf-ft]</p>	 <p>TE-CC1510 38 N-m [28 lbf-ft]</p>
<p><b>TE-CC1515</b></p>	<p><b>TE-CC1513</b></p>	<p><b>TE-CC1510</b></p>

## GRIPPER MOUNTS



Tech-Effector Gripper Mounts secure the gripper to the tooling system. The spherical ball enables orbital adjustment. Many options to adapt to various manufactures.

### Features

- High strength aluminum
- Connection to TE-RT Tubing
- Orbital  $\pm 30^\circ$  adjustability
- Adapts to many popular brands

### Ordering Information

Part No.	Description	Weight
TE-GRM2-M-1.50R	Gripper Mount, GRM2 Gripper to 1.50 inch Diameter Tubing	0.41 kg [0.90 lbs]
TE-PGS20-M-1.50R	Gripper Mount, PGS20 Gripper to 1.50 inch Diameter Tubing	0.38 kg [0.84 lbs]

- Additional options available upon request

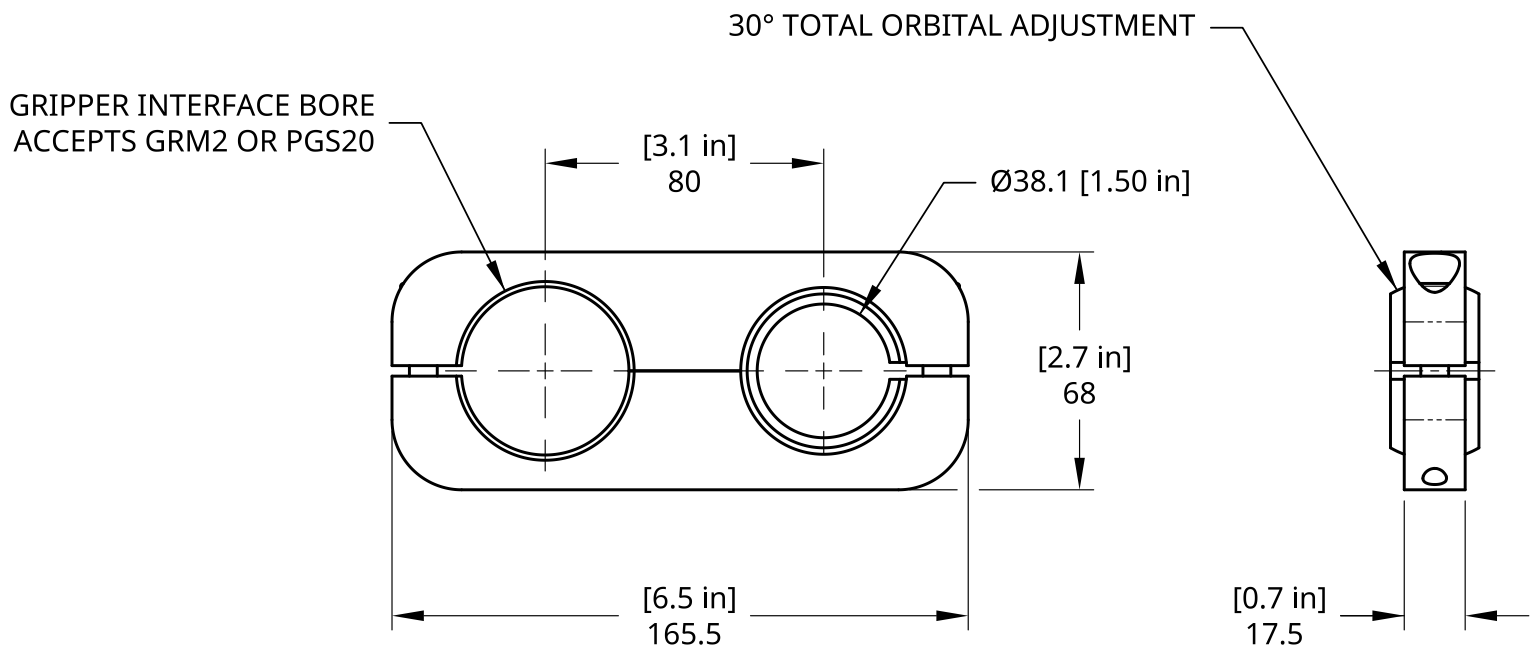

## END EXTENSION



Tech-Effector TE-ES1 End Extension provides connection and adjustability to “Apple-Core” style items. Vacuum cup mounts, vacuum generators, proximity sensors, etc. It’s available in various length options.

### Features

- “Apple-Core” style connection
- Black anodize finish
- 1.00 inch diameter rod
- High strength aluminum

### Ordering Information

Part No.	Description	Weight
TE-ES1-100	End Extension, 1.00 inch diameter, 100mm long	0.14 kg [0.31 lbs]
TE-ES1-150	End Extension, 1.00 inch diameter, 150mm long	0.17 kg [0.38 lbs]
TE-ES1-200	End Extension, 1.00 inch diameter, 200mm long	0.21 kg [0.46 lbs]
TE-ES1-250	End Extension, 1.00 inch diameter, 250mm long	0.24 kg [0.53 lbs]
TE-ES1-300	End Extension, 1.00 inch diameter, 300mm long	0.28 kg [0.61 lbs]

- Additional options available upon request

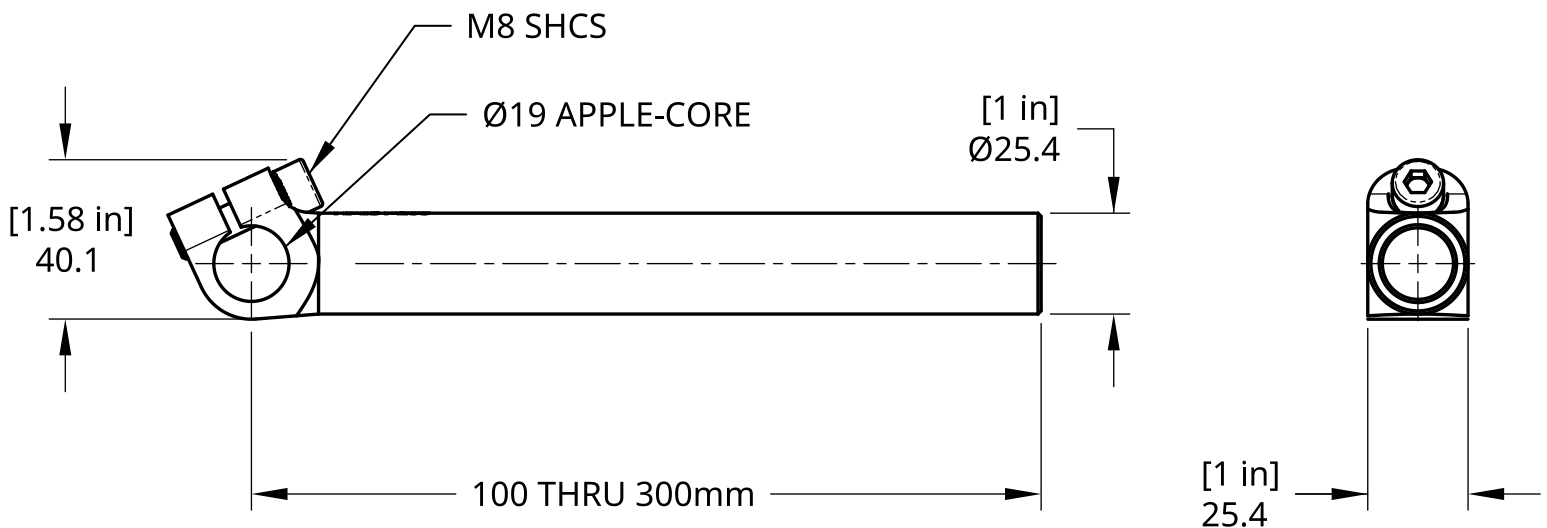



## PORT ADAPTER



Tech-Effector TE-PA-1 Port Adapter is a vacuum cup mount. It connects to TE-ES1 End Extension via “Apple-Core” style. Includes porting for connection to a vacuum source.

### Features

- Black anodize finish
- Connection to TE-ES1
- High strength aluminum

### Ordering Information

Part No.	Description	Weight
TE-PA-1	Port Adapter, 3/8 NPT Male, 1/4 NPT Female, Apple-Core	0.07 kg [0.14 lbs]

- Additional options available upon request

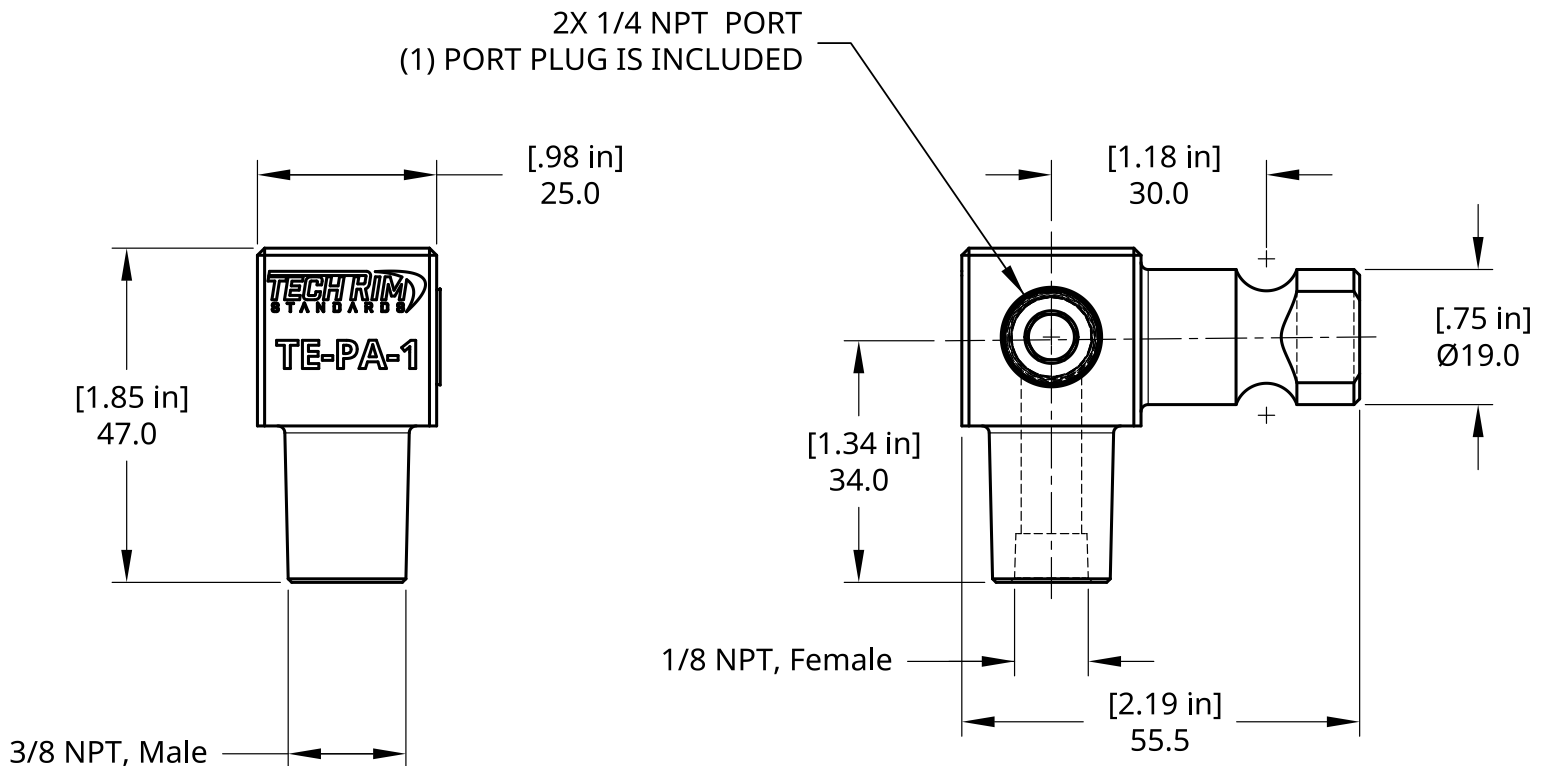

## SPRING CUP MOUNT



Tech-Effector TE-SCM Spring Cup Mount is used to provide compliance between the tooling and object being picked up. Connection to tooling via “Apple-Core” post.

### Features

- Anti-rotate bushing for alignment
- Connection to TE-ES1
- “Apple-Core” tooling connection

### Ordering Information

Part No.	Description	Weight
TE-SCM-075-U14-NR	Spring Cup Mount, 19mm stroke, 3/8 NPT Male x 1/4 NPT Female	0.15 kg/m [0.34 lbs]
TE-SCM-19-G14-NR	Spring Cup Mount, 19mm stroke, 3/8 ISGO Male x 1/4 ISOG Female	0.15 kg/m [0.34 lbs]

- Additional options available upon request

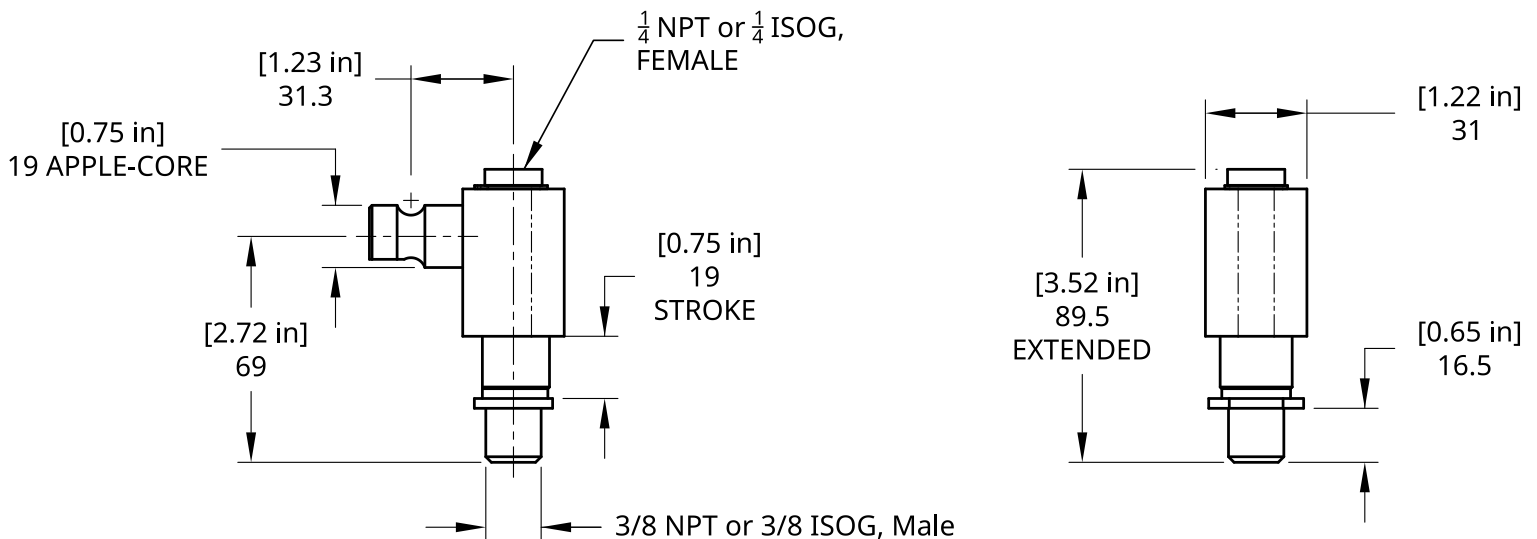

## SENSOR MOUNT



Tech-Effector TE-SM Sensor Mount is designed for 40mm “Cube-Style” and threaded “Barrel-Style” proximity sensors. It connects to the tooling system via industry standard 19mm “Apple-Core” or 1-1/8 inch spherical ball.

### Features

- Black anodize finish
- Connection to TE-ES1
- High strength aluminum
- Accommodates barrel and 40mm cube sensors

### Ordering Information

Part No.	Description	Weight
TE-SM-C40-18-AC	Sensor Mount, 40mm Cube, 18mm hole, Apple-Core Mount	0.05 kg [0.10 lbs]
TE-SM-C40-30-AC	Sensor Mount, 40mm Cube, 30mm hole, Apple-Core Mount	0.04 kg [0.08 lbs]
TE-SM-C40-18-B112	Sensor Mount, 40mm Cube, 18mm hole, 1.125 inch Ball	0.05 kg [0.10 lbs]
TE-SM-C40-30-B112	Sensor Mount, 40mm Cube, 30mm hole, 1.125 inch Ball	0.05 kg [0.10 lbs]

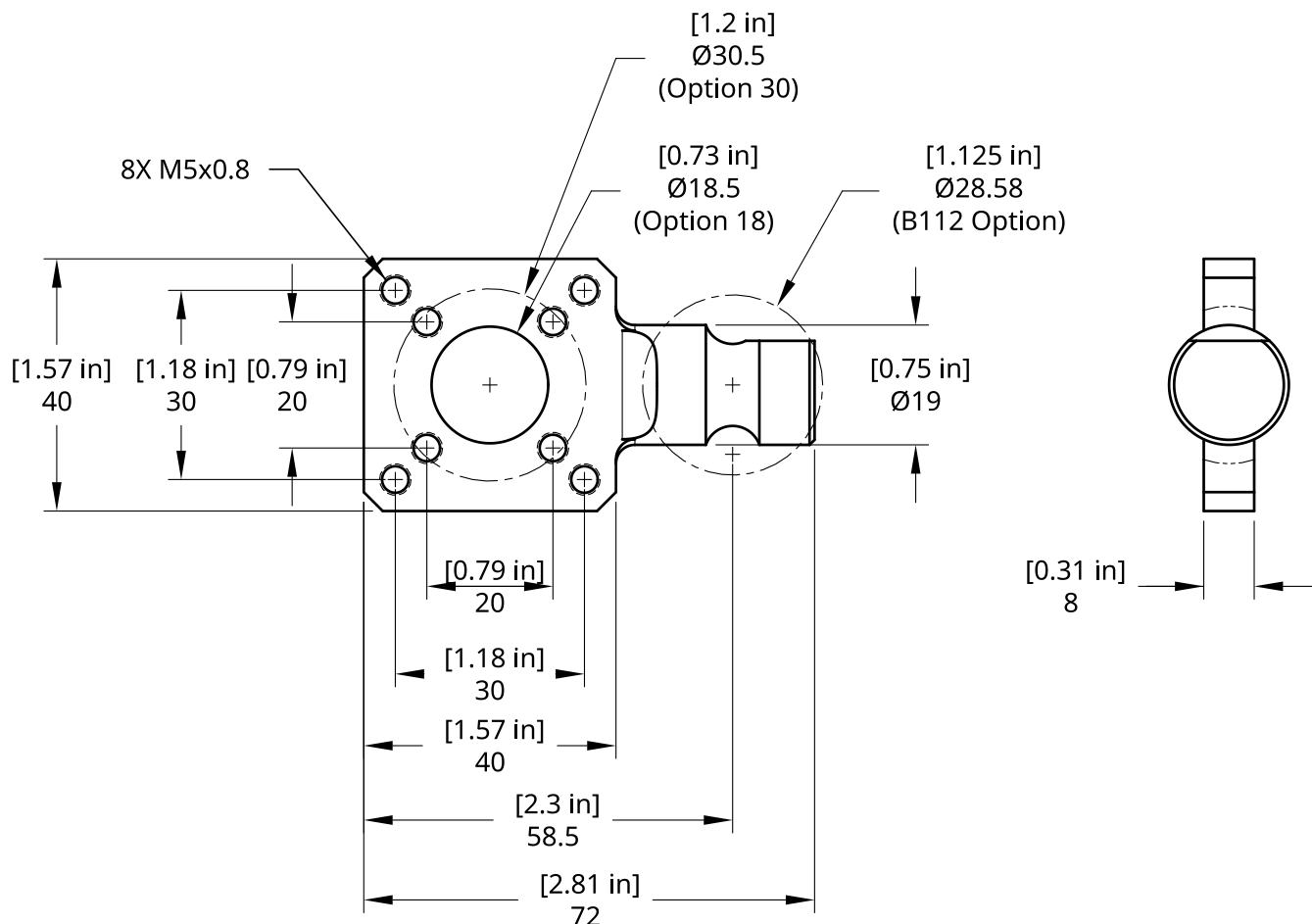



## NAAMS

- WORLD'S LARGEST INVENTORY OF NAAMS STANDARD COMPONENTS
- STANDARDIZED PARTS FOR MANY DIVERSE INDUSTRIES / MARKETS
- EURO STANDARDS



## CLAMPS AND GRIPPERS

- EC SERIES CLAMPS HAVE A 'BEFORE CENTER' LOCKING MECHANISM
- EC CLAMPS HAVE 100S OF OPTIONS FOR FACTORY AUTOMATION SOLUTIONS
- STRONG - YET COMPACT, GL/GH GRIPPERS HAVE 5 CYLINDER OPTIONS
- OUR GRIPPERS HAVE OVER 50 HEAD COMBINATIONS

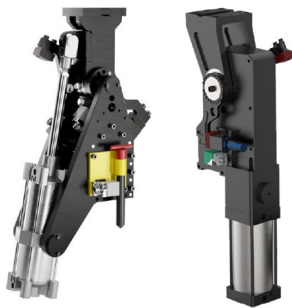

## PIVOT UNITS

- VERY POPULAR 'OFF THE SHELF' PNEUMATIC UNITS
- INDUSTRY LEADING - FULLY ADJUSTABLE!
- MULTIPLE CYLINDER AND MOUNTING OPTIONS
- UNIQUE AND COMPACT DESIGN

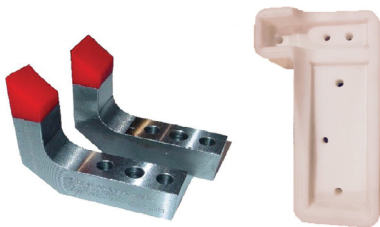

## NC/DETAIL COMPONENTS

- WE DESIGN AND CONSTRUCT THOUSANDS OF CUSTOM COMPONENT ANNUALLY
- HIGH QUALITY - LOW COST!
- HUNDREDS OF MATERIAL CAPABILITIES
- SMALL BATCH TO HIGH PRODUCTION



## AUTOMATION / TRANSFER

- SHUTTLES, SLIDES AND LIFT UNITS
- CONVEYOR ROLLERS - IN 3 INDUSTRIAL OPTIONS
- 'UNIVERSAL' MOUNTED ROBOT SPACERS
- OPEN ARCHITECTURE CLAMPING SYSTEMS