

TECH-WINDER™

Instruction Manual

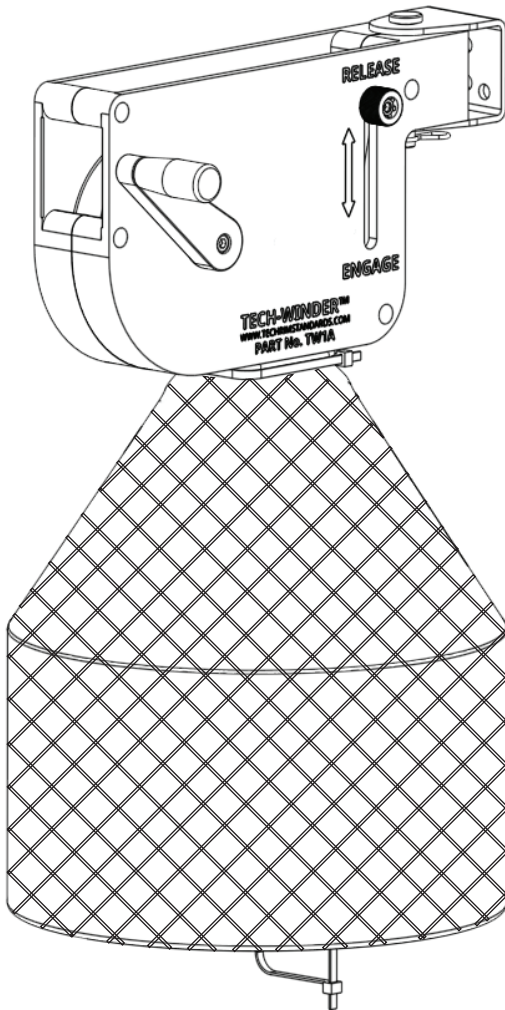

US Patent# 11,530,110

Product No.

TW1A

Operating the TECH-WINDER

Once the Tech-Winder is mounted and cable insertion steps are complete, you're ready!

To unwind: Move the lever up into the latched Release position, grab the cable and walk away as far as the cable will allow.

To wind: Push the level handle down until it locks into the engage position. Rotate the handle and voila!

Tips for Success

It's best to leave the Tech-Winder in the upward latched release position when not in use. Only place in the Engage position during winding. Doing so will allow speedy unwinding. Additionally, it will insure that any undue compression set doesn't take place on the cable.

If you don't like the handle location, that's ok. Grab a 5mm hex key and reinstall the handle on the opposite side.

LIMITED WARRANTY. All product ("Equipment") manufactured by TechRim Standard's, LLC ("TechRim") is warranted against defects in workmanship and materials under normal use and service for __ [____] days from the date of delivery (the "Limited Warranty"), but only when installed and operated in accordance with the User's and Maintenance Manual. If any failure to conform to this Warranty appears during the warranty period, TechRim shall, upon notification and substantiation that the Equipment have been used in accordance with the User's Manual, correct such defects by either suitable repair, replacement, or purchase price refund at TechRim's option and expense, provided BUYER returns the defective Equipment to TechRim, freight prepaid. Compliance with this provision by BUYER shall be a condition of this Limited Warranty. Any Equipment modification or repair other than that authorized by TechRim in writing shall void the Limited Warranty. This Limited Warranty does not cover any warranty of components incorporated into the Equipment that is manufactured by third-parties, such as but not limited to pneumatic cylinders. THIS LIMITED WARRANTY IS EXCLUSIVE AND IS IN LIEU OF ANY AND ALL OTHER WARRANTIES, INCLUDING WITHOUT LIMITATION ANY WARRANTY OF MERCHANTABILITY, FITNESS FOR A PARTICULAR PURPOSE, OR OTHER WARRANTY OF QUALITY, WHETHER EXPRESS OR IMPLIED. NEITHER ORAL STATEMENTS NOR WRITTEN STATEMENTS OTHER THAN THIS LIMITED WARRANTY CONSTITUTE WARRANTIES. TechRim SHALL NOT UNDER ANY CIRCUMSTANCE BE LIABLE FOR SPECIAL OR CONSEQUENTIAL DAMAGES, such as, but not limited to, damage or loss of other property or Equipment, loss of profits or revenue, injury to goodwill, cost of processing, cost of capital, cost of purchased or replacement Equipment, or any claims of customers of BUYER for loss of profits or revenue, service interruptions or otherwise.

Mount Instructions

holes size: 8.5mm. Vertical pattern distance: 21mm
Diagonal pattern distance: 40mm

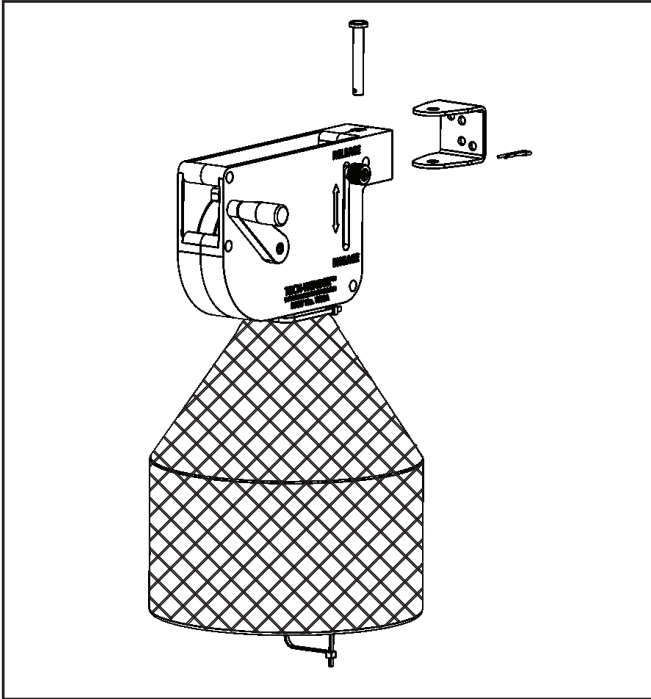

STEP: 1

To mount, choose between diagonal pattern or vertical hole pattern. Vertical pattern is for extrusion mounting. Accepts M6 or M8.

STEP: 2

With the mount bracket secured, insert the Tech-Winder into the mount. Then insert the locking pin from above to secure the Tech-Winder into position. Finally, secure the pin by inserting the locking clip into the bottom of the pin.

Cable Insertion (Method 1)

Method 1 is the most common for new installation.

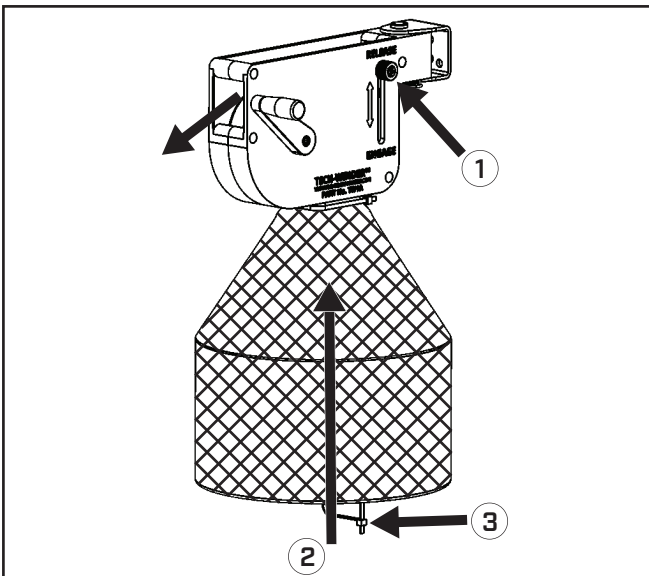

STEP: 1

Pull up lever and lock it into the release position.

STEP: 2

Insert the cable into the opening in the bottom of the net all the way up through the top of the Tech-Winder and through the front opening.

STEP: 3

Secure the cable to the net using the provided cable tie.

Cable Insertion (Method 2)

Method 2 is a great solution for a couple scenarios. Use this method when;

- a) Some cables have large connectors too big to fit through the Tech-Winder.
- b) If you want to install the Tech-Winder while automation is up and running. This will avoid disconnecting any cables, powering down, E-Stop, loss of production, etc.

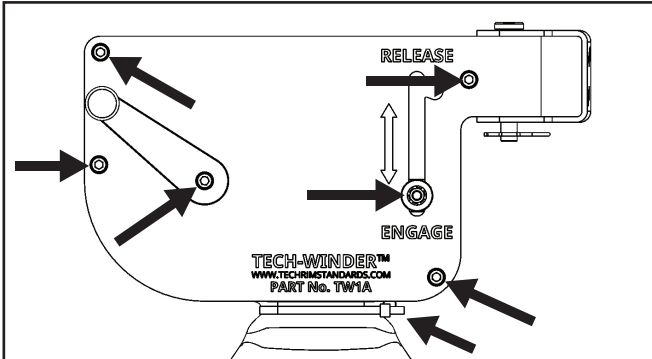

STEP: 1

Loosen reusable cable tie and temporarily remove net.

STEP: 2

Loosen M6 fasteners [5mm hex key] separating housing.

STEP: 3

Thread cable through net and place cable in housing as shown.

STEP: 4

Reassemble housing and tighten all M6 fasteners.

STEP: 5

Replace net onto the winder and secure cable tie

STEP: 6

Secure the second cable to the net as shown

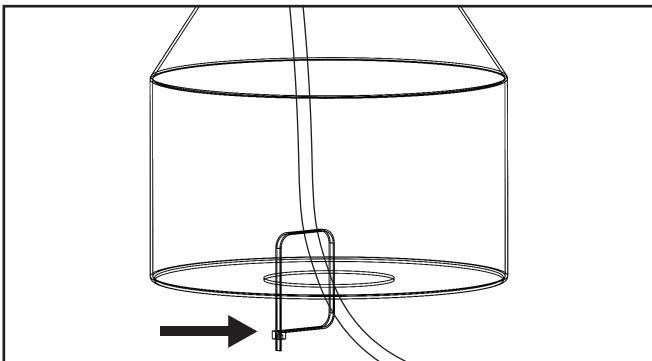
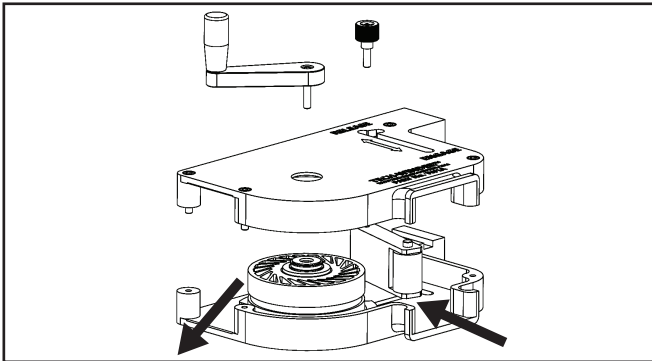

SAFETY INFORMATION

CAUTION: Never use cords above their rated capacity. Never use old cords that are frayed, weather cracked, cut, or damaged in any way as these may cause harm. ALWAYS follow cord manufacturers recommendations for load ratings and any usage recommendations on cord or cord packaging.